

TRANSFORMERS

AUTOBOT JAZZ

LEVEL: 0 1 2 3 **4** 5
ADVANCED

AUTOBOT



WARNING:
CHOKING HAZARD—Small parts.
Not for children under 3 years.

AGES 5+
19764/21364 Asst.

NOTE: Some parts are made to detach if excessive force is applied and are designed to be reattached if separation occurs. Adult supervision may be necessary for younger children.

CHANGING TO ROBOT

AUTOBOT JAZZ

1. Lift the roof panel.
2. Fold the roof panel down.
3. Rotate the roof panel.
4. Move the front wheel assembly.
5. Deploy the front fenders.
6. Rotate the front fenders.
7. Move the front engine components.
8. Rotate the front engine components.
9. Rotate the front engine components.
10. Rotate the front engine components.
11. Rotate the front engine components.
12. Rotate the front engine components.
13. Rotate the front engine components.
14. Rotate the front engine components.
15. Rotate the front engine components.
16. Rotate the front engine components.
17. Rotate the front engine components.
18. Rotate the front engine components.

ROBOT MODE

REVERSE ORDER OF INSTRUCTIONS TO CONVERT BACK TO VEHICLE.

CHANGING TO BLASTER

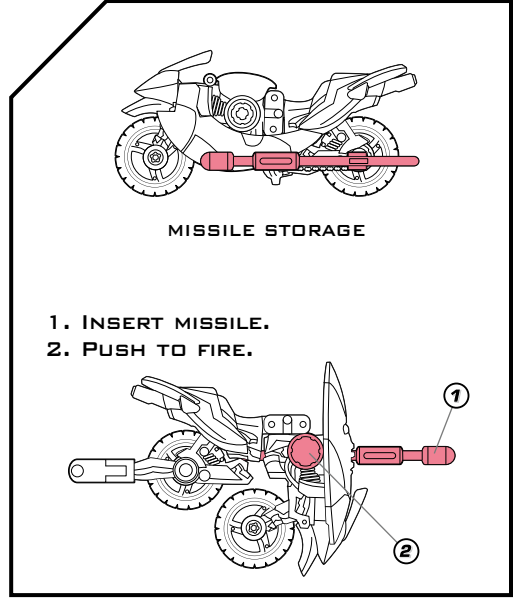
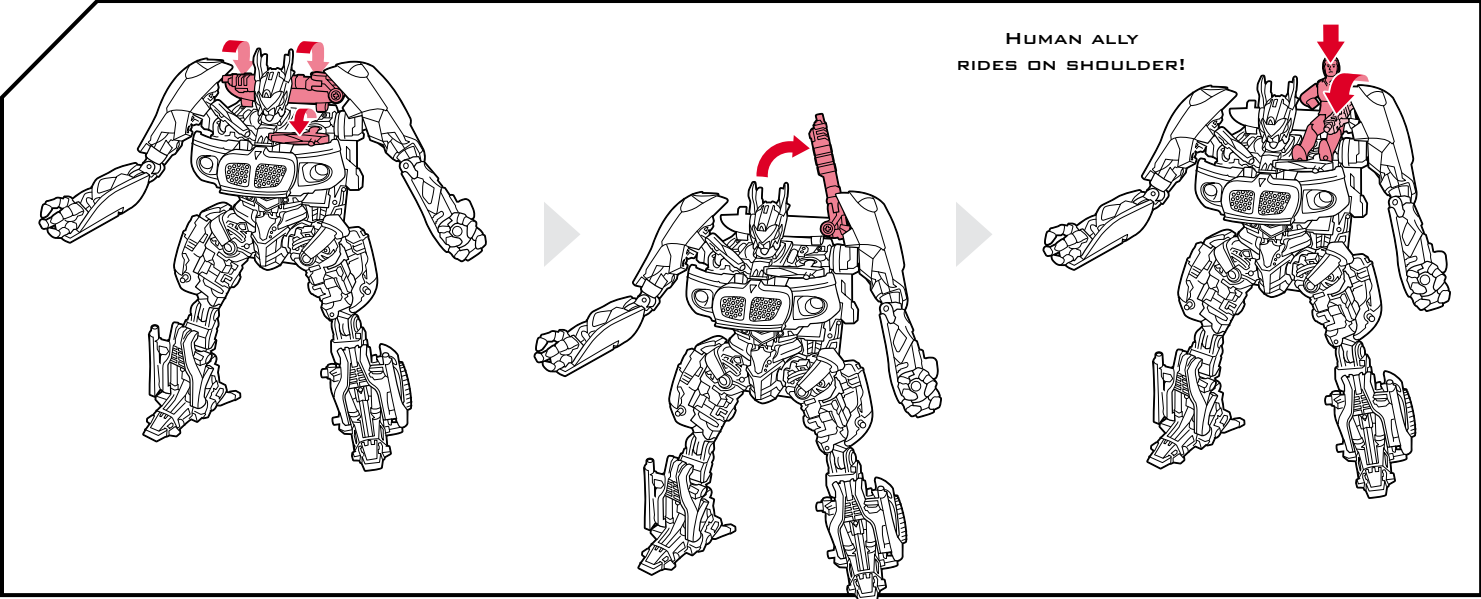
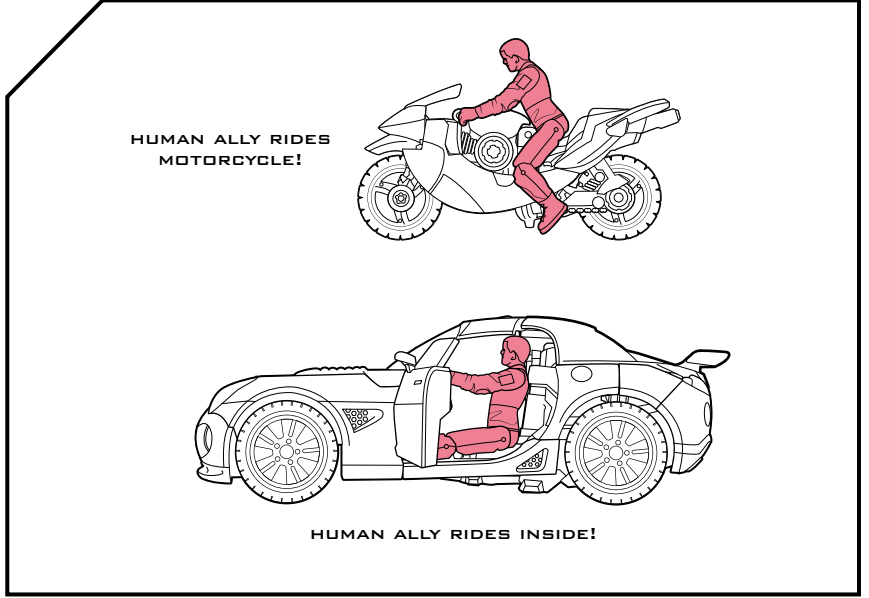
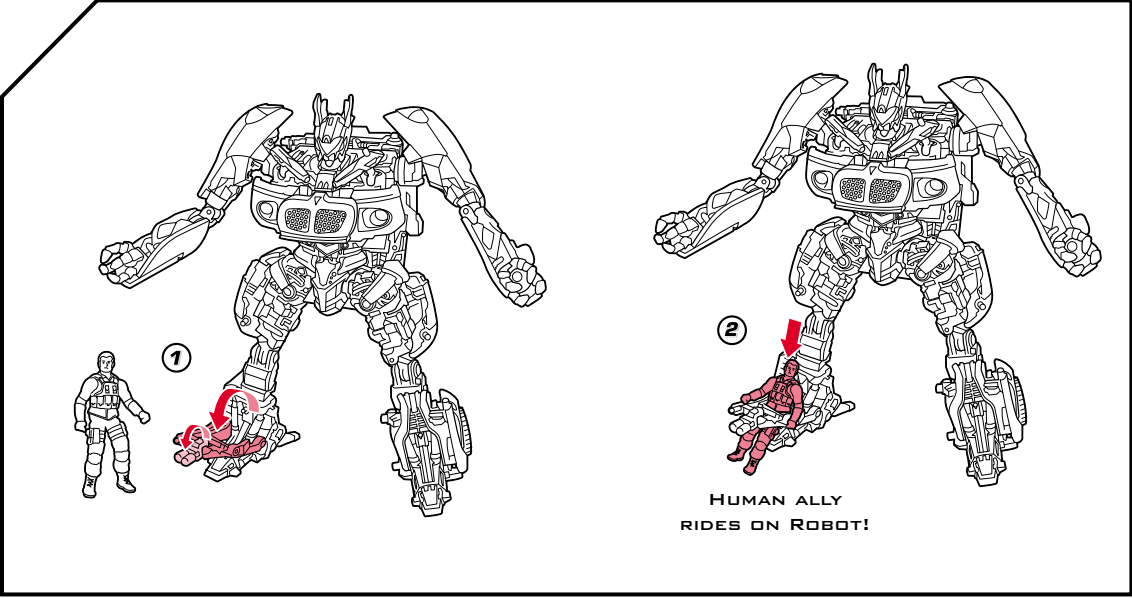
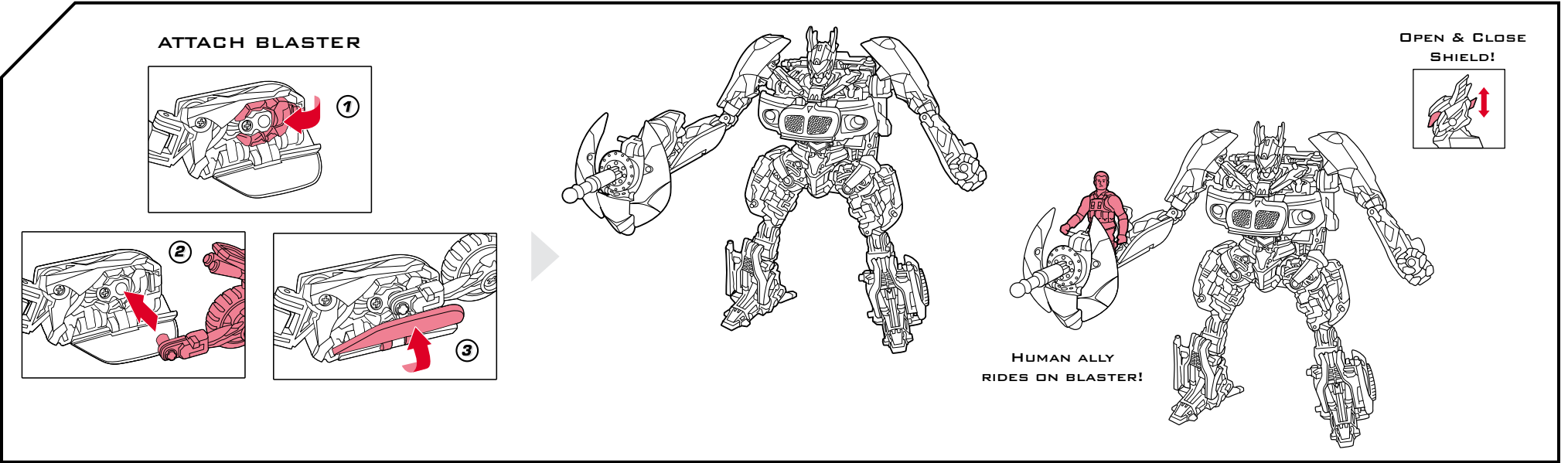
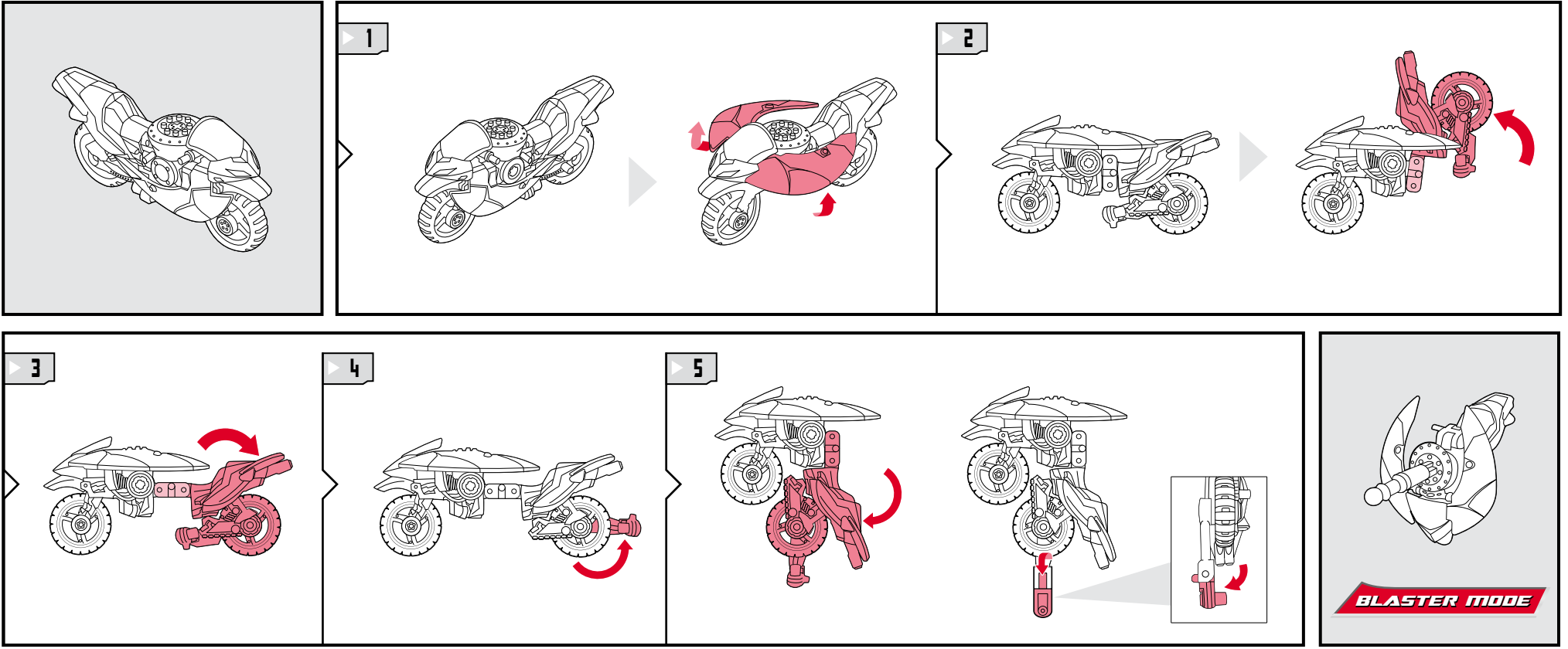

Hasbro © 2010 DreamWorks LLC & Paramount Pictures Corporation
 ® and/or TM* & © 2010 Hasbro. All Rights Reserved.
 TM & © denote U.S. Trademarks.
 Manufactured under license from Tomy Company, Ltd.

DREAMWORKS PICTURES



P/N 7057910000

Product and colors may vary.

Some poses may require hand support.

Retain instructions for future reference.



NEED HELP?
TRANSFORMERS.COM/INSTRUCTIONS

! Not suitable for children under 3 years because of small parts - choking hazard.



Pontiac, Solstice and all related Emblems and vehicle body designs are General Motors Trademarks used under license to Hasbro, Inc.